

## IEC Pin and Sleeve

**“Reverse Service” Unfused Circuit-Lock® Mechanical Interlocks**IP67  
SUITABILITY*Features and Benefits*

Large gears enclosed in a gear box assembled on one plane to eliminate possible gear jumping.

Color coded rating pad and receptacle mount to signify voltage.

Lockable handle to meet OSHA Lockout/Tagout regulations.

Two-stage interlocking mechanism to help defeat tampering.

Watertight conduit hub and grounding plate for use on metallic conduit.

Pre-wired IEC Pin and Sleeve reverse service receptacle.

Solid pins—dependable solid brass for longer life and reliable electrical contact.

Captured neoprene gasket for a watertight seal.

Horsepower rated disconnect switch handles large motor loads.

DIN rail mounted switch for easy installation and replacement.

Enclosure housing with brass inserts and stainless steel screws for higher torque and better sealing.

Spring-loaded liftcover with gasket for a watertight seal.

Adjustable mounting feet are ductile to allow mounting on irregular surfaces.

Three molded-in conduit drill points are located on top, bottom and back surface of enclosure.

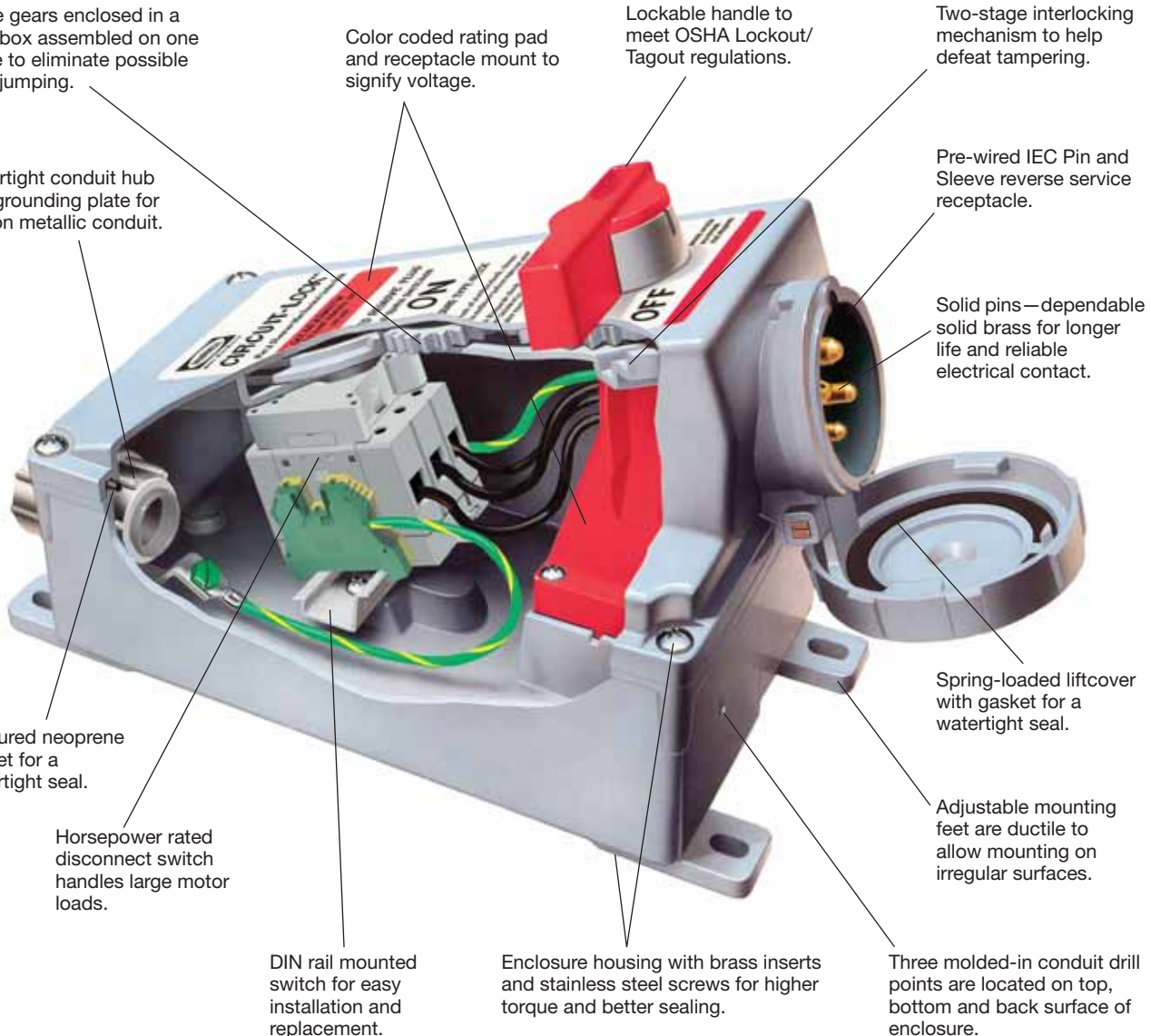
**Hubbell Circuit-Lock® Reverse Service Mechanical Interlocks**

The National Electric Code requires a separate disconnect means within sight of all motor loads. The NEC requires the disconnecting means in a motor-circuit be listed as “Suitable as Motor Disconnect” if the motor is rated greater than 2 HP.

Hubbell’s “Reverse Service” Circuit-Lock® Mechanical Interlock incorporates the disconnect switch and reverse service receptacle (inlet) in one compact non-metallic and economical unit.

At the same time, it eliminates the possibility of making or breaking the circuit under load or making a casual or “lazy” connection.

The switch cannot be turned ON until the reverse service plug has been inserted properly, and the reverse service plug cannot be removed until the switch is turned OFF. The non-metallic enclosure can be connected to metallic conduit and not interfere with the ground continuity.

These horsepower rated units are durable, watertight and easy to install and all “Reverse Service” Circuit-Lock® Mechanical Interlocks can be locked out as a method of compliance with OSHA Lockout/Tagout regulation.

These Circuit-Lock® units are available in 30, 60 and 100A, 4 wire configurations.

## IEC Pin and Sleeve

## “Reverse Service” Unfused Circuit-Lock® Ordering Information

30, 60 and 100 Ampere – North American Ratings

IP67  
SUITABILITY

Amps	Poles & Wires	Configuration Recep./ Conn.	Plug/ Inlet	Voltage	Mechanical Interlock	Mating Plug
30	3P 4W			3Ø 240	HBL430MI9WR	HBL430P9WR
	3P 4W			3Ø 480	HBL430MI7WR	HBL430P7WR
	3P 4W			3Ø 600	HBL430MI5WR	HBL430P5WR
60	3P 4W			120/240	HBL460MI12WR	HBL460P12WR
	3P 4W			3Ø 240	HBL460MI9WR	HBL460P9WR
	3P 4W			3Ø 480	HBL460MI7WR	HBL460P7WR
	3P 4W			3Ø 600	HBL460MI5WR	HBL460P5WR
100	3P 4W			120/240	HBL4100MI12WR	HBL4100P12WR
	3P 4W			3Ø 240	HBL4100MI9WR	HBL4100P9WR
	3P 4W			3Ø 480	HBL4100MI7WR	HBL4100P7WR
	3P 4W			3Ø 600	HBL4100MI5WR	HBL4100P5WR

Note: 30A – 1.0 inch N.P.T. hub supplied; 60 and 100A – 1¼ inch hub supplied.

## Auxiliary Contacts for 30, 60 and 100A switch, A600 pilot duty

Description	Catalog Number
“Break After Main Break”, 1 set of n/o contacts, 1 set of n/c contacts.	HBLAC1
“Break Before Main Break”, 1 set of n/o contacts.	HBLAC2

## Ground Block

Description	Catalog Number
For 30A switches.	HBL30RGB
For 60A and 100A switches.	HBL60100RGB

## Neutral Block

Description	Catalog Number
For 30A switches.	HBL30RNB
For 60A switches.	HBL60RNB
For 100A switches.	HBL100RNB

## Watertight Closure Plug Kits

Description	Catalog Number
For 30A Circuit-Lock Unfused and Fused Pin and Sleeve mechanical interlocks.	MICPK30
For 60A and 100A Circuit-Lock Unfused and Fused Pin and Sleeve mechanical interlocks.	MICPK60

## Replacement Switches

Description	Catalog Number
For 30A switches.	HBL30MIRS
For 60 and 100A switches.	HBLDS60100RS

## Replacement Mounting Feet

Description	Catalog Number
For 30, 60 and 100A mechanical interlocks.	HBLRFT2*

\*Package of 10 feet and 10 screws.



HBLAC1



HBLAC2



HBL30RGB



MICPK30



HBL30MIRS



HBLRFT2

# IEC Pin and Sleeve “Reverse Service” Unfused Circuit-Lock® Specifications

## Specifications

### Typical Specifications

Manufacturer's Description	Identification Hubbell HBL460MI7WR Circuit-Lock® Pin and Sleeve Reverse Mechanical Interlock.
Electrical Type	3 Pole + Earth.
Rating	60A, 480V AC 3 Phase.
Configuration	IEC 60309-2 Clock position 7.
Enclosure Type	Outdoor-4X (Watertight, Washdown) Indoor-12 (Dust-tight, Falling Dirt and Noncorrosive Liquids).
Ingress Protection	IP67 Suitability.
Enclosure Material	Non-metallic, enclosure suitable for metallic conduit.
Certification	UL Listed, CSA Certified.
Materials	UV resistant thermoplastic Valox® top and base. High heat thermoset interiors, 300 series stainless steel enclosure screws, zinc conduit hub.

## Performance

### Electrical

Dielectric Voltage	Withstands 3,000V AC Min.
Max. Working Voltage	600V AC RMS.
Current Interrupting	Certified for current interrupting.
Short Circuit Withstand Rating	Suitable for use on a circuit capable of delivering not more than 10,000 RMS symmetrical amperes at the voltage rating of the receptacle.
Operations	Mechanical 10,000 cycles, electrical 6,000 cycles.

### Mechanical

Impact Resistance	In accordance with UL 746C.
Terminal Identification	In accordance with UL, CSA and international conventions.
Product Identification	Identification and rating are part of the external label and molded into the receptacle mount.
Mounting	External adjustable feet.

### Environmental

Moisture Resistance	Outdoor-4X (Watertight, Washdown) Indoor-12 (Dust-tight, Falling Dirt and Noncorrosive Liquids).
Ingress Protection	IP67 Suitability.
Flammability	UL94-5VA and V-0 Classification.
Operating Temperature	Max. Continuous 75°C; Min. Continuous -40°C.
UV Resistance	All materials are UV stabilized.

## Dimensions

KEY	30A Inches (mm)	60A Inches (mm)	100A Inches (mm)
A	7.75 (196.9)	7.75 (196.9)	7.75 (196.9)
B	6.87 (174.5)	6.87 (174.5)	6.87 (174.5)
C	4.75 (120.7)	4.75 (120.7)	4.75 (120.7)
D	1.02 (25.9)	1.02 (25.9)	1.02 (25.9)
E	1.60 (40.6)	1.46 (37.1)	1.46 (37.1)
F	11.00 (279.4)	12.75 (323.9)	12.75 (323.9)
G	8.75 (222.3)	8.75 (222.3)	8.75 (222.3)
H	8.00 (203.2)	9.75 (247.7)	9.75 (247.7)
I	10.12 (257.0)	11.87 (301.5)	11.87 (301.5)
J	6.88 (174.8)	6.88 (174.8)	6.88 (174.8)
K	1.93 (49.0)	2.09 (53.1)	2.09 (53.1)
L	11.00 (279.4)	13.65 (346.7)	13.65 (346.7)
M	7.75 (196.9)	8.60 (218.4)	9.30 (236.2)
HUB SIZE	1.00" N.P.T.	1.25" N.P.T.	1.25" N.P.T.

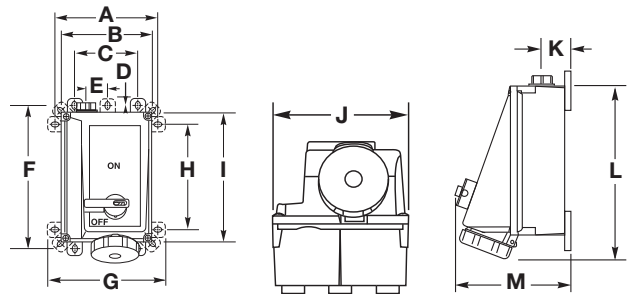

## Horsepower Ratings

Amps	Poles & Wires	Rating	Horsepower	Catalog Number	Reverse Service Plug Catalog Number
30	3P 4W	3Ø 240V AC	7.5	HBL430MI9WR	HBL430P9WR
30	3P 4W	3Ø 480V AC	15	HBL430MI7WR	HBL430P7WR
30	3P 4W	3Ø 600V AC	20	HBL430MI5WR	HBL430P5WR
60	3P 4W	120/240V AC	7.5	HBL460MI12WR	HBL460P12WR
60	3P 4W	3Ø 240V AC	15	HBL460MI9WR	HBL460P9WR
60	3P 4W	3Ø 480V AC	30	HBL460MI7WR	HBL460P7WR
60	3P 4W	3Ø 600V AC	40	HBL460MI5WR	HBL460P5WR
100	3P 4W	120/240V AC	15	HBL4100MI12WR	HBL4100P12WR
100	3P 4W	3Ø 240V AC	25	HBL4100MI9WR	HBL4100P9WR
100	3P 4W	3Ø 480V AC	50	HBL4100MI7WR	HBL4100P7WR
100	3P 4W	3Ø 600V AC	50	HBL4100MI5WR	HBL4100P5WR

Valox® is a trademark of SABIC Innovative Plastics, acquired from General Electric Company.