



Industrial Power Cord Reels

Cord End	Cable Feet (m)	Cable Type	NEMA Style	Amps	Volts AC	Weight Lbs. (kg)	Catalog Number
Without cord ends.	50 (15.2)	16/3 SJEO	—	10	125	20 (9.1)	HBL50163
Without cord ends.	45 (13.7)	12/3 SJEO	—	20	125	21 (9.5)	HBL45123
HBL5269C connector.	45 (13.7)	12/3 SJEO	5-15R	15	125	28 (12.7)	HBL45123C
HBL5369C connector.	45 (13.7)	12/3 SJEO	5-20R	20	125	28 (12.7)	HBL45123C20
HBL5369C connector, (white reel housing).	45 (13.7)	12/3 SJEO	5-20R	20	125	28 (12.7)	HBL45123C20W
HBL2313 connector.	45 (13.7)	12/3 SJEO	L5-20R	20	125	28 (12.7)	HBL45123TL20
HBL2313 connector, (white reel housing).	45 (13.7)	12/3 SJEO	L5-20R	20	125	28 (12.7)	HBL45123TL20W
Portable outlet box with (1) gray duplex receptacle.	45 (13.7)	12/3 SJEO	5-15R	15	125	29 (13.2)	HBL45123R
	45 (13.7)	12/3 SJEO	5-20R	20	125	29 (13.2)	HBL45123R20
Same as above except white.	45 (13.7)	12/3 SJEO	5-20R	20	125	29 (13.2)	HBL45123R20W
Portable outlet box with (2) gray duplex receptacle.	45 (13.7)	12/3 SJEO	5-20R	20	125	29 (13.2)	HBL45123R220
Same as above except white.	45 (13.7)	12/3 SJEO	5-20R	20	125	29 (13.2)	HBL45123R220W
Black portable outlet box with (1) gray duplex receptacle, (white reel housing).	45 (13.7)	12/3 SJEO	5-20R	20	125	29 (13.2)	HBL45123R20WM1
Portable outlet box with (1) ground fault protected gray duplex receptacle.	45 (13.7)	12/3 SJEO	5-15R	15	125	29 (13.2)	HBL45123GF15
	45 (13.7)	12/3 SJEO	5-20R	20	125	29 (13.2)	HBL45123GF20

Note: 15 Amp: Supplied with 5 ft. power supply cord with HBL5266C, 15A straight blade plug. 20 Amp: Supplied with 5 ft. power supply cord with HBL5366C, 20A straight blade plug. Ground fault protected reels supplied with (1) GFM20 and (1) HBLP26FS.



HBL45123R20WM1



HBL45123GF15



HBL340PB

Accessories

Description	Weight Lbs. (kg)	Catalog Number
Pivot base 340° rotation fits all industrial models.	5 (2.3)	HBL340PB
Replacement stop.	.2 (.09)	HBL12BS

Dimensions

Inch (mm)	A	B	C	D	E	F
	13.00" (330)	12.38" (314)	8.00" (203)	2.50" (64)	9.75" (248)	1.25" (32)

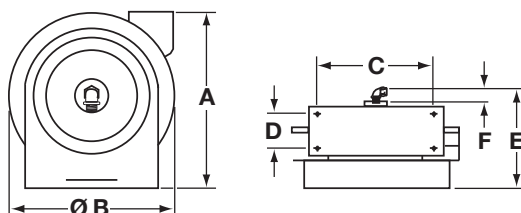

Note: All models have four .625" (15.9) diameter mounting holes.

Listing/Certification

UL 355
 CSA C22.2 No. 21.

Environment

Dry, indoor, non-hazardous locations.

Mounting Positions

Wall mount.
 Ceiling mount.
 Bench mount.

Dimensions in Inches (mm)