

Ceiling Incandescent Pendant

41581L
INSTALLATION SHEET

START FROM HERE

- Make sure **POWER** is **COMPLETELY OFF** at the fuse box
- Have your fixture installed by a qualified licensed electrician
- Prepare everything in a clear area
- Wear gloves at all time during this installation
- Read instructions carefully before you start assembly
- Keep this installation sheet for future reference

Technical Support: 1-855-855-8926

- 1.** Remove the fixture from its original packaging. Remove the mounting crossbar (**1c**) from within the canopy (**2a**) by removing the side screws (**1f**). Secure the mounting crossbar (**1c**) to the reinforced junction box (**1a**) using screws (**1d**) provided in the hardware package.
- 2.** Before you mount the canopy (**2a**) to the mounting crossbar (**1c**) please select the desired length you wish the pendant to hang. Using an allen key, shorten or lengthen the SVT wire by simply turning the set screw out (**2b**) and where the wire comes through the canopy (**2a**) push or pull the wire to your desired length then lock the set screw (**2b**) with the allen key and the wire will stay in place.
- 3.** You are now ready to mount the canopy (**2a**) to the mounting crossbar (**1c**). First connect all wires (**1b**) correctly, black to black "L", white to white "N" and the ground to ground with the provided marrets from the hardware package. Push the canopy up towards the ceiling and line up holes on the side of the mounting crossbar (**1c**) to the holes on the sides of the canopy (**2a**) and tighten side screws (**1f**) with screw driver.
- 4.** Install the bulb into the lamp holder (**3a**) (bulb not included).
- 5.** You have now completed the installation of your fixture, enjoy.

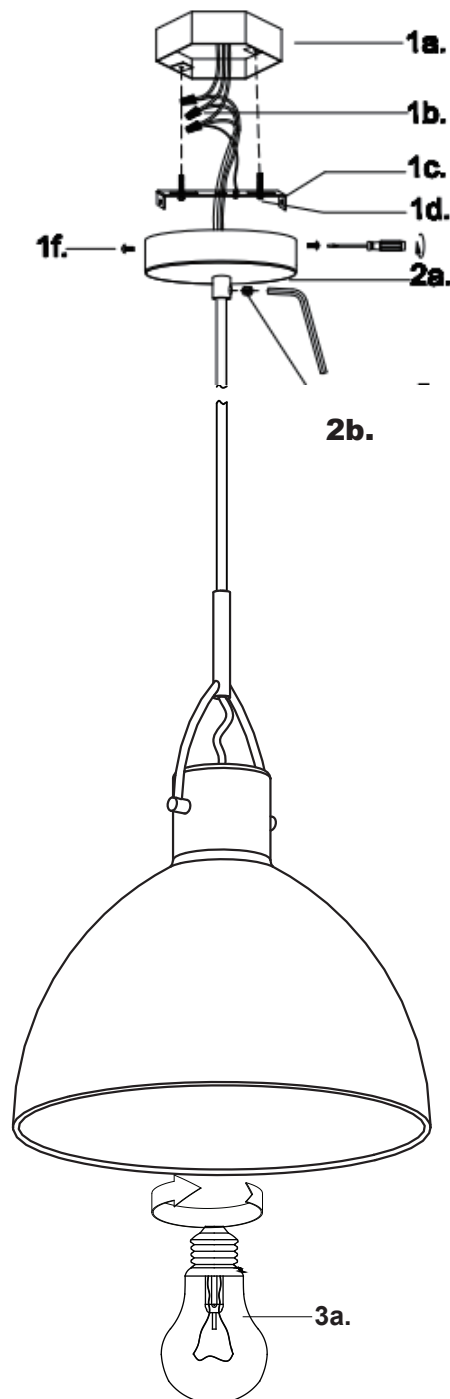

KUZCO

19054 28th Avenue Surrey, BC Canada V3Z 6M3
T: 604 538 7162 TF: 1-855 85 KUZCO F: 604 538 7196
W: kuzcolighting.com
20200414